

#### **Warning to Spectators**

Motor racing is dangerous and accidents causing death, bodily injury, disability and property damage can happen!

The suggested spectator points were designed to provide you with access to view the competitors in action and for this to happen safely for you, your fellow spectators, the event officials and competitors.

There are several strict rules you must observe.

- Do **NOT** stand on the roads used by the competitors as part of the course or as a possible escape route.
- Do **NOT** ignore the requests of any event officials regarding your safety or the parking of your cars. Should this warning **NOT** be heeded and the safety of any party is in doubt then the organisers will stop competitors from starting the stage and you may be asked to leave the area. If necessary, your actions may be reported to the Police.
- This rally is only possible due to the co-operation of local authorities, Forest Corporation of NSW, the NSW Police and we ask that you drive to and from the spectator points in a responsible manner displaying courtesy to other road users; Remove any litter that you may have carried to

## **Spectator Point 1 – Bega Showground**

**Directions to get there:** Bega Showground is located on the corner of Upper Rd and Tathra Rd, Bega.

Parking is available outside of the show ring. Food and drink will be available here.

See the cars. Meet the drivers. Cars will assemble at the Bega Showground prior to the Start of the Event. First car is flagged away on Saturday at **1:00 pm** and returns after 3 special stages at **2:19pm**. Following a short 20 minute service, the crews will then head south for another stage before a further service will be completed in Boydtown (see Spectator Point 2).

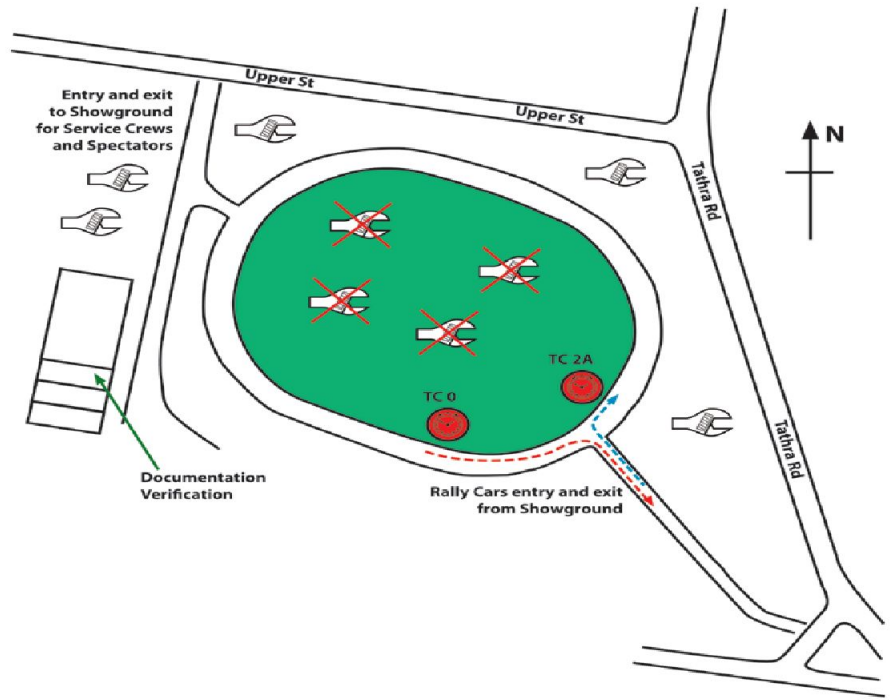

## Spectator Point 2 – Boydtown Service Park – Saturday 9th June

**Directions to get there:** Travel south from Bega to Eden and then continue south for 7km to Boydtown Park Rd and TURN LEFT and follow for 700 metres to Boydtown.

Crews are due to arrive at the Boydtown Service Park following **Stage 4** which is held between Bega and Boydtown, the first car is due to arrive at **4:05pm**. The cars will be in service for a 60 minute Service/Meal break offering plenty of opportunity to get around and see the service crews in action carrying out repairs and also to chat with the drivers and co-drivers. Food and drink will be available here.

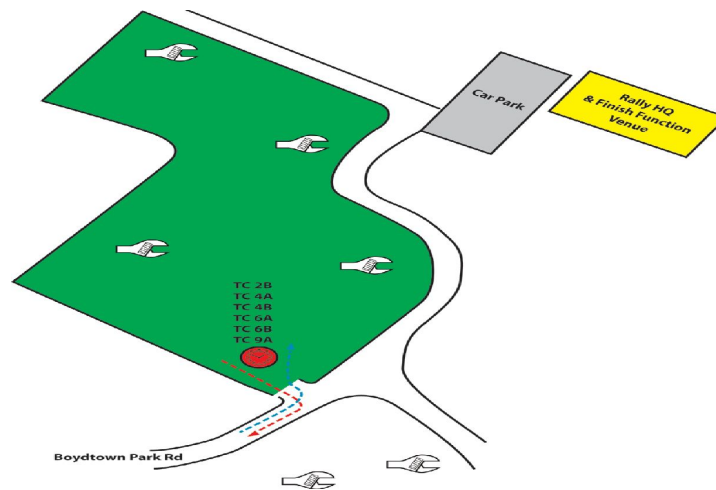

## Spectator Point 3 – Wombat – Saturday 9<sup>th</sup> June – First Car Due 6:00 pm

**Directions to get there:** From the Service Park at Boydtown, return to the Princes Hwy and TURN LEFT. Continue for 11km and TURN RIGHT onto Burrawang Rd (gravel road). Follow this road for 750mtrs and turn your car around and park on the left. The spectator point is just ahead. Try to arrive approx. 10mins before the First Car is due to secure your vantage spot.

Spectator point 3 Cars approach downhill and turn hard right.

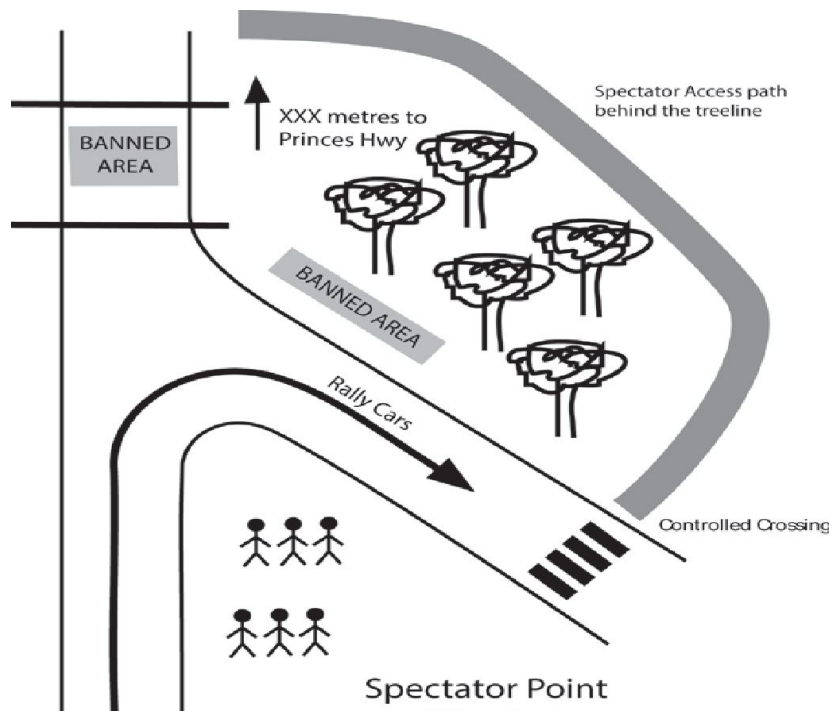

## Spectator Point 4 – Mountain Road – Sunday 10th June – First Car due 8:27am

**Directions to get there:** From the Service Park at Boydtown, return to the Princes Hwy and **TURN LEFT**. Continue for 20.6km and **TURN LEFT** onto the Ireland-Timms Rd (gravel road). Follow this road for 570mtrs and turn your car around and park on the left. The spectator point is just ahead. Try to arrive approx. 10mins before the First Car is due to secure your vantage spot.

Cars approach along a fast uphill stretch and turn hard left uphill.

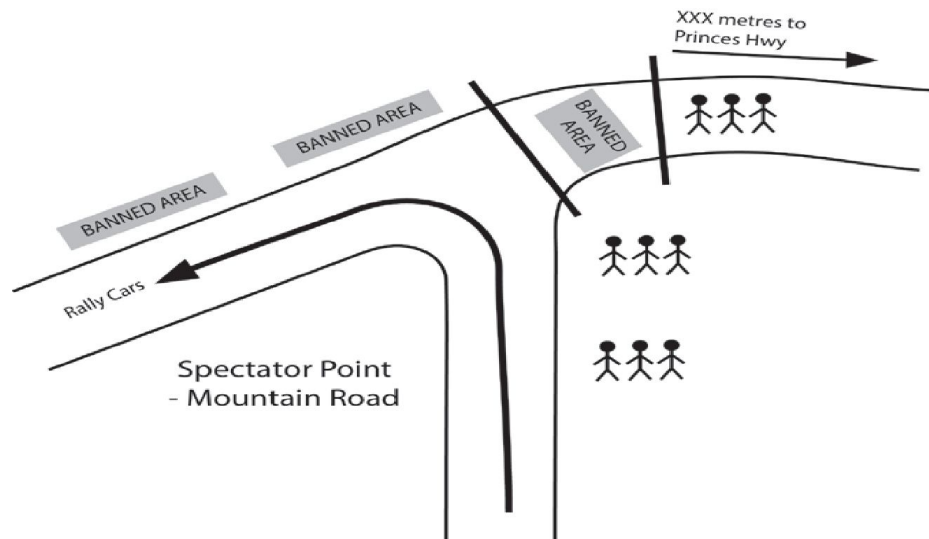

## Spectator Point 5 – Wombat Reverse – Sunday 10<sup>th</sup> June – First Car Due 12:20pm

**Directions to get there:** From the Service Park at Boydtown, return to the Princes Hwy and **TURN LEFT**. Continue for 11km and **TURN RIGHT** onto Burrawang Rd (gravel road). Follow this road for 750mtrs and turn your car around and park on the left. The spectator point is just ahead. Try to arrive approx. 10mins before the First Car is due to secure your vantage spot.

Spectator point 5 cars approach in the reverse direction to diagram shown below

